

TYPE 54 - Kugelschleifstifte / Ball-end grinding points

Bestell-Nr. FIS Order-No.	Bestell-Nr. D+Z Order-No.	D mm	S mm	L1	L4	Standardkörnungen, <i>standard grit</i>			
						D76	D107	D126	D181
ID5402002	872	2,0	3	50	4	0	0	0	
ID5403003	873	3,0	3	50	3	0	0		0
ID5404004	874	4,0	3	50		0	0	0	0
ID54040L4	874/L	4,0	6	60	7	0	0		0
ID5405005	875	5,0	3	50		0	0		0
ID54050L5	875/L	5,0	6	60	6	0	0		0
ID5406006	876	6,0	3	50		0	0		0
ID54060L6	876/L	6,0	6	60	5	0	0		0
ID5407007	877	7,0	6	60				0	
ID5408008	878	8,0	6	60				0	
ID5409009	879	9,0	6	60				0	
ID5410010	880	10,0	6	60				0	
ID5412012	881	12,0	6	60				0	

0 = Standardabmessung / 0 = standard dimension

INFO

Standardkörnungen, *standard grit*
Körnungs-Code, *grit-code*

D76 D107 D181
[./1] [./2] [./3]

Empfohlene Einspannlänge,
Recommended clamping length

$L_3 = 0,5 \times L_1$

TOLERANZEN, TOLERANCES

Schaft, *shank*
Längen, *lengths*
Durchmesser, *diameter*

h7
 $\pm 0,20$ mm
 $\pm 0,15$ mm

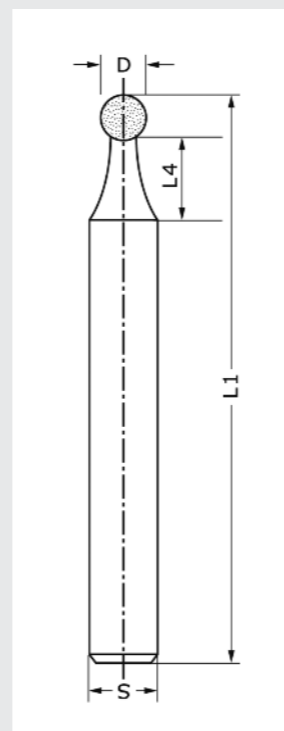
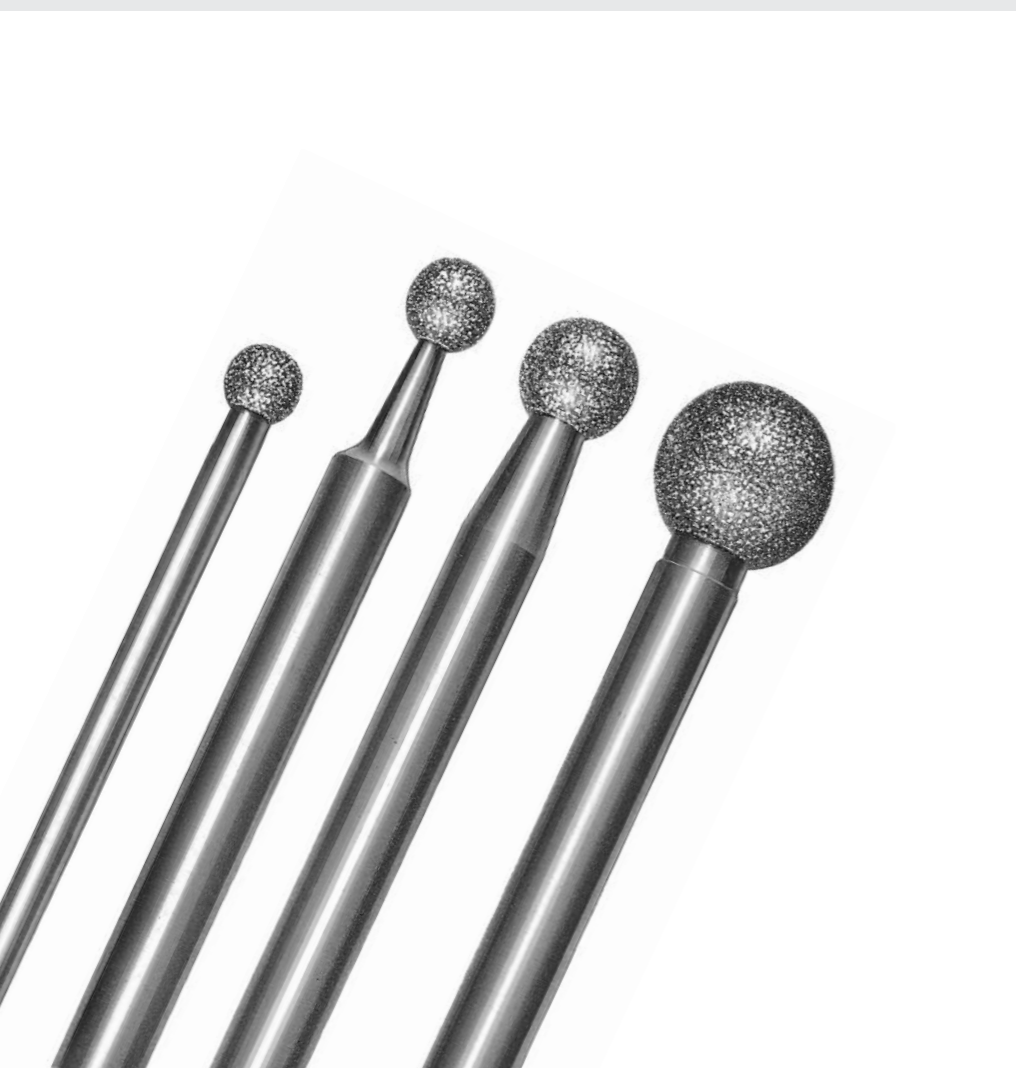

Certified quality:
DIN EN ISO 9001:2008

diamant/cbn industrie



Schleifstifte der Marke D+Z
D+Z trade mark mandrels

D+Z Schleifstifte
D+Z Mandrels

TYPE 50

D+Z Schleifstifte
D+Z Mandrels

TYPE 51

D+Z Kugelschleifstifte
D+Z Ball-end grinding points

TYPE 54

Diamant und CBN (Cuboron 1000®)
Diamond and CBN (Cuboron 1000®)

03/2016

Finzler, Schrock & Kimmel GmbH
Arzbacher Straße 55-57
D-56130 Bad Ems
Tel.: +49 (0) 26 03 / 9 60 30
Fax: +49 (0) 26 03 / 9 60 3-70
e-Mail: industrie@fis-online.com
Internet: www.fis-online.com



TYPE 50 - Schleifstifte (kurze Schäfte) / Mandrels (short shanks)

Bestell-Nr. FIS Order-No.	Bestell-Nr. D+Z Order-No.	D mm	T mm	S mm	L1	L4	Diamant- und CBN-(Cuboron 1000®) Korngrößen diamond and CBN (Cuboron 1000®) grit sizes									
							D76	D107	D126	D181	B76	B107	B151	B251		
ID5000503	830	0,5	3	3	40	5	O					O				
ID5000603	831	0,6	3	3	40	8	O					O				
ID5000703	832	0,7	3	3	40	8	O	O	O			O	O			
ID5000803	833	0,8	3	3	40	8	O	O	O			O	O			
ID5000903	834	0,9	3	3	40	7	O	O	O			O	O			
ID5001003	835	1,0	3	3	40	7	O	O	O			O	O			
ID5001203	836	1,2	3	3	40	9	O	O	O			O	O			
ID5001504	837	1,5	4	3	40	10	O	O	O			O	O			
ID5001804	838	1,8	4	3	40	10	O	O	O			O	O	O		
ID5002004	839	2,0	4	3	40	12	O	O	O			O	O	O		
ID5002504	840	2,5	4	3	40	15	O	O	O			O	O	O		
ID5003005	841	3,0	5	3	40	15	O	O		O		O	O	O	O	
ID5003505	842	3,5	5	3	50		O	O		O		O	O	O	O	
ID5004005	843	4,0	5	3	50		O	O		O		O	O	O	O	
ID50040L5	843/L	4,0	5	3	75		O	O		O		O	O	O	O	
ID5004505	844	4,5	5	3	50		O	O	O			O	O	O	O	
ID50045L5	844/L	4,5	5	3	75		O	O	O			O	O	O	O	
ID50045B5	844/B	4,5	5	6	60	27	O	O	O			O	O	O	O	
ID5005005	845	5,0	5	3	50		O	O		O		O	O	O	O	
ID50050L5	845/L	5,0	5	3	75		O	O		O		O	O	O	O	
ID50050B5	845/B	5,0	5	6	60	27	O	O	O			O	O	O	O	
ID5006006	846	6,0	6	6	60	24	O	O	O			O	O	O	O	
ID50060L6	846/L	6,0	6	6	100	64	O	O	O			O	O	O	O	
ID5007008	847	7,0	8	6	60		O	O	O			O	O	O	O	
ID50070L8	847/L	7,0	8	6	100		O	O	O			O	O	O	O	
ID5008008	848	8,0	8	6	60		O	O	O			O	O	O	O	
ID5009010	855	9,0	10	6	60		O	O	O			O	O	O	O	
ID5009L10	855/L	9,0	10	6	100		O	O	O			O	O	O	O	
ID5010005	851	10,0	5	6	60		O	O	O			O	O	O	O	
ID5010L10	849/L	10,0	10	6	100		O	O	O			O	O	O	O	
ID5012005	852	12,0	5	6	60		O	O	O			O	O	O	O	
ID5012010	854	12,0	10	6	60		O	O	O			O	O	O	O	
ID5012L10	854/L	12,0	10	6	100		O	O	O			O	O	O	O	
ID5015005	853	15,0	5	6	60		O	O	O			O	O	O	O	
ID5015010	850	15,0	10	6	60		O	O	O			O	O	O	O	
ID5015L10	850/L	15,0	10	6	100		O	O	O			O	O	O	O	

O = Standardabmessung / O = standard dimension

INFO

Standardkörnungen, <i>standard grit</i>	D76	D107	D181	
Körnungs-Code, <i>grit-code</i>	[./1]	[./2]	[./3]	
	B76	B107	B151	B251
	[./4]	[./5]	[./6]	[./7]

Empfohlene Einspannlänge, *Recommended clamping length* L₃ = 0,5 x L₁

TOLERANZEN, TOLERANCES

Schaft, <i>shank</i>	h7
Längen, <i>lengths</i>	± 0,20 mm
Durchmesser, <i>diameter</i>	91 +0,10 -0,20
	126 +0,15 -0,15
	151 +0,25 -0,05
	181 +0,35 +0,05
	252 +0,45 +0,15

TYPE 51 - Schleifstifte (lange Schäfte) / Mandrels (long shanks)

Bestell-Nr. FIS Order-No.	Bestell-Nr. D+Z Order-No.	D	T	S	L1	L4	Diamant- und CBN-(Cuboron 1000®) Korngrößen diamond and CBN (Cuboron 1000®) grit sizes								
							D76	D107	D181	B76	B107	B151	B251		
ID5103005	841/C	3,0	5	3	75	49	O	O	O	O	O	O	O	O	
ID5103505	842/C	3,5	5	3	75		O	O	O	O	O	O	O	O	
ID5104005	843/C	4,0	5	4	50	26	O	O	O	O	O	O	O	O	
ID51040L5	843/CL	4,0	5	4	75	49		O			O	O	O	O	
ID5104505	844/C	4,5	5	4	50			O			O	O	O	O	
ID51045L5	844/CL	4,5	5	4	75		O	O			O	O	O	O	
ID5105005	845/C	5,0	5	4	50		O	O	O			O	O	O	O
ID51050L5	845/CL	5,0	5	4	75		O	O	O			O	O	O	O
ID5108008	848/C	8,0	8	6	100		O	O	O			O	O	O	O
ID51080L8	848/CL	8,0	8	8	100	63		O	O			O	O	O	O
ID5109010	855/C	9,0	10	8	100		O	O	O			O	O	O	O
ID5110010	849/C	10,0	10	8	110		O	O	O			O	O	O	O
ID5111010	856/C	11,0	10	10	110		O	O	O			O	O	O	O
ID5111210	854/C	12,0	10	10	110		O	O	O			O	O	O	O
ID5111310	857/C	13,0	10	10	110		O	O	O			O	O	O	O
ID5111410	858/C	14,0	10	10	110		O	O	O			O	O	O	O
ID5111510	850/C	15,0	10	10	110		O	O	O			O	O	O	O
ID5111610	859/C	16,0	10	10	110		O	O	O			O	O	O	O
ID5111810	860/C	18,0	10	10	110		O	O	O			O	O	O	O
ID5120010	861/C	20,0	10	10	110		O	O	O			O	O	O	O
ID5122010	862/C	22,0	10	10	110		O	O	O			O	O	O	O
ID5125010	863/C	25,0	10	10	110		O	O	O			O	O	O	O

O = Standardabmessung / O = standard dimension

INFO

Standardkörnungen, <i>Standard grit</i>	D76	D107	D181	
Körnungs-Code, <i>Grit-code</i>	[./1]	[./2]	[./3]	
	B76	B107	B151	B251
	[./4]	[./5]	[./6]	[./7]

Empfohlene Einspannlänge, *Recommended clamping length* L₃ = 0,5 x L₁

TOLERANZEN, TOLERANCES

Schaft, <i>shank</i>	h7
Längen, <i>lengths</i>	± 0,20 mm
Durchmesser, <i>diameter</i>	91 +0,10 -0,20
	151 +0,25 -0,05
	181 +0,35 +0,05
	252 +0,45 +0,15

